

- L-198 - U.S. to Francis Oliver - S 1/4 of S.E. 1/4 Sec. 28, T. 7. N. 16. 1. W
- M. 32 F. Oliver to Oscar Short same
- M-126 - O. Short to Geo. M. T. Campbell, - Beg. 20.02 ch N. + 5.65 ch E. of S.W. cor 1/4
E. 89.4 ch - N 93 1/4° E. 14.40 ch - N 79 1/2° W 11.66 ch - S 17.02 to beg
- M. 139 O. Short to Wm Jones - Beg. S.E. cor 1/4 - W. 20 ch - N 5. ch - 20 ch - S 5. ch to beg
- O. 601 " " " James Ward - Beg. S. ch N of S.E. cor 1/4 N 15. ch - W 2.25 ch - S.W. along
Rice Cr. to pt 17.00 ch W. of beg. E. to beg.
- Q. 41 Elisha Warren to Osker Short. Beg. 20. ch S. + 20.31 ch E. of N.W. cor
1/4 - E 16.75 ch - N 24 3/4° W 7. ch - W 19.69 ch - S 6.35 ch to beg
- Q-251 - Oscar Short to Elizabeth White Ensdling - Beg. 3. ch N. of S.W. cor, 1/4
E. 5.65 ch - N 17. ch - W 5.65 ch - S 17. ch to beg.
- S-170 Oscar Short to Ruth Walker - Beg. 20.02 ch N. + 14.59 ch E. of S.W. cor 1/4
N 9 3/4° E. 14.40 ch - N 9 3/4° E 14 rods - W 15 1/2, 14 ft. S 11 Rods
S 79 1/2° E. 16 R. to pt. at N.E. cor of Lena Campbell's field (back)
- U. 393 - Richard Jones jr. to Oscar Short - Beg. 11.02 ch - E. of N.W. cor. N.E. 1/4 33.
S 4.62 ch - W 20 R. 14 1/2 ft. - N 23 R. E 20 R 14 1/4 ft. S 4 1/2 to beg
- W 304 Cecelia White to John Jones - beg. 13. ch N. of S.W. cor 1/4 E 5.65 ch N 7. ch
W 5.65 S 7. ch to beg.
- W 327 - Celia White to John Henry Woodfield - beg. 13. ch N. of S.W. cor 1/4
E 5.65 ch - S 7 1/2, 1 1/2 ft - W 5.65 ch - N 7 R. 1 1/2 ft to beg
- X 612 Celia White to Temple Short - Beg. 3. ch N. of S.W. cor 1/4 - E 5.65
N 8 1/2 ch - W. 5.65 ch - S 8 1/2 ch to beg.
- Z-320 J. H. Wood field to Thos. Wallace - all W-327. - W. 304 -
- 6-420 Temple Short to Anson Thornton - all X 612 -
- 9-282 - Richard Jones jr. to Edwin James Rickford - Beg. 12.39 ch E. of
N.W. cor. N.E. 1/4 33 - S. 4.62 ch - E 1.89 ch - N 6.64 ch -
W 1.89 ch - S 2.02 to beg.

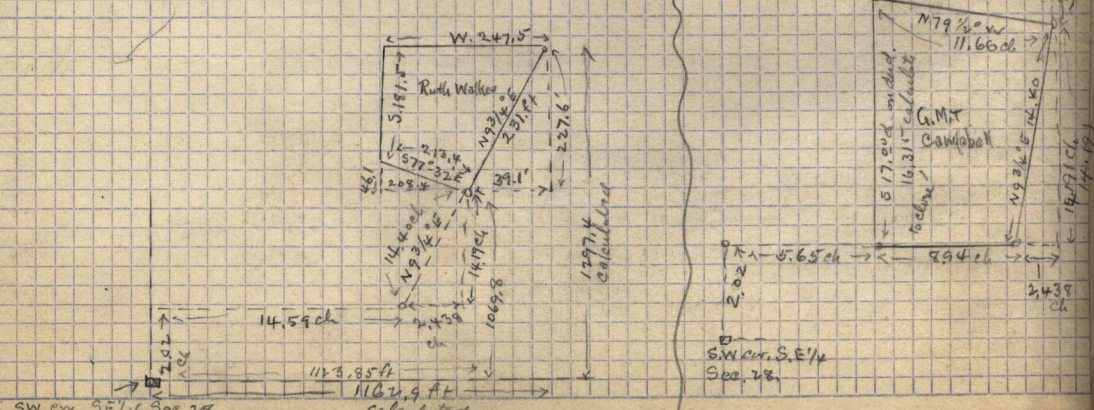

SW. cor. S.E. 1/4 Sec. 28